



CJ19 Contactor for Capacitor Switching

1.General

1.1 Electric ratings: AC50/60Hz, up to 690V;

1.2 Standard: IEC/EN 60947-4-1



2.Type designation

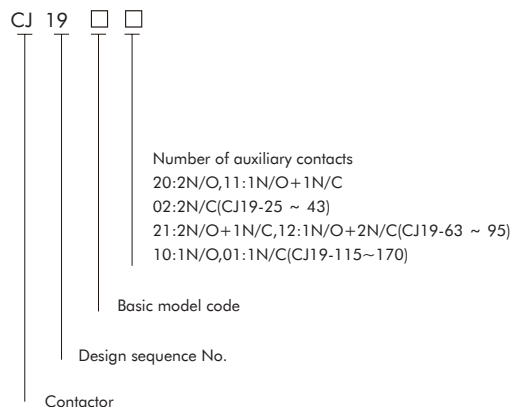

3. Operating conditions

3.1 Ambient temperature: -5℃ ~ +40℃, the average during 24 hours should not exceed +35℃;

3.2 Altitude: ≤ 2000m;

3.3 Atmosphere conditions: At mounting site, relative humidity not exceed 50% at the max temperature of +40℃, higher relative humidity is allowable under lower temperature. For example, RH could be 90% at +20℃, special measures should be taken to occurrence of dews;

3.4 Pollution degree: 3

3.5 Installation category: III

3.6 Installation conditions: the inclination between installation plane and vertical plane is within ±5°

3.7 Impact and shake: the products should locate in the places where there are no obvious impact and shake.

3.8 Protection class: IP10

4. Technical data

Item		CJ19-25	CJ19-32	CJ19-43	CJ19-63	CJ19-95	CJ19-115	CJ19-150	CJ19-170
Controll able capacitor Capacity	220/230V	6.7	10	15	20	35	40	46	50
	380/400V	12.5	20	25	33.3	50	60	80	90
	660/690V	18	26	36	48	92	100	120	130
Rated Isolation Voltage Ue V		690							
Rated Operational Voltage Ue V		220/230V,380/400V,660/690V							
Conventional thermal current I th A		25	32	43	63	95	200	200	275
Reted Operational current Ie A(380V)		17	23	29	43	72.2	87	115	130
Restrained surge capacity		20 Ie							
Capacity of Auxiliary contact		AC-15:Ie:0.95A Ue:380/400V DC-13:Ie:0.15A Ue:220/250V Conventional thermal current I th:10A							
Operating Frequency cycles/h		120							
Electrical durability 10 ⁴		10					2		
Mechanical durability 10 ⁴		100					300		

5. Overall and mounting dimensions (mm)

CJ19-25~43

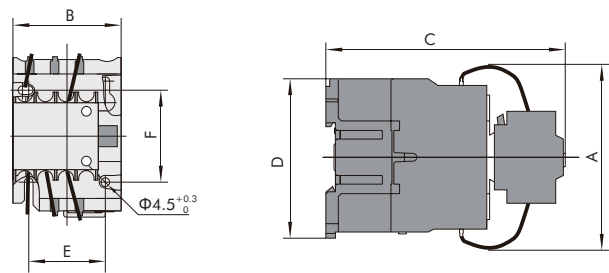

CJ19-63~95

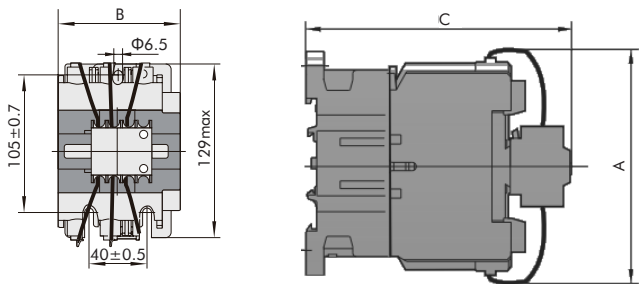

CJ19-115~170

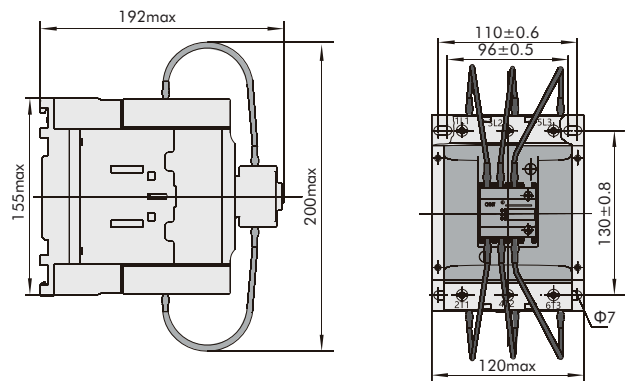

Model	Amax	Bmax	Cmax	Dmax	E	F	Note
CJ19-25	80	47	124	76	34/35	50/60	Not only fixed by screws but also could be fixed with 35mm din rail
CJ19-32	90	58	132	86	40	48	
CJ19-43	90	58	136	86	40	48	
CJ19-63	132	79	150	-	-	-	Not only fixed by screws but also could be fixed with 35mm and 75mm din rail
CJ19-95	135	87	158	-	-	-	
CJ19-115	200	120	192	155			Not only fixed by screws but also could be fixed with two 35mm din rail
CJ19-150	200	120	192	155			
CJ19-170	200	120	192	155			

6. Wiring and installation

6.1 The connection terminals are protected through insulation cover, which is reliable and secure for installation and operation;

6.2 For CJ19-25~43, screws are available for installation, as well as the DIN rail;
for CJ19-63~95, 35mm or 75mm standard rail are available for installation.
for CJ19-115~170, screws are available for installation, as well as two 35mm DIN rail.