

# PRODUCT DATASHEET

## FLOODLIGHT VALUE 50 W 4000 K IP65 BK

FLOODLIGHT VALUE | Floodlight



### Areas of application

- Replacement for floodlights with halogen lamps
- Car parks and underpasses
- Public areas
- Building facades
- Construction areas

### Product benefits

- Energy savings of up to 80 % compared to halogen lamp floodlights
- Semi-frosted, tempered glass cover for uniform illumination
- Quick and simple installation thanks to low profile, compact and light weight design
- 3 years guarantee

### Product features

- Luminous efficacy: up to 90 lm/W
- Symmetrical beam angle: 110° x 110°
- Mounting bracket for up to 180° tilting
- Type of protection: IP65
- Impact resistance: IK06 (10 W to 50 W), IK08 (from 100 W)
- Ambient temperature in operation: -20...+45 °C



---

**TECHNICAL DATA****Electrical data**

Nominal wattage	50.00 W
Nominal voltage	220...240 V
Mains frequency	50...60 Hz
Nominal current	220 mA
Inrush current	6 A
Inrush current time $T_{h50}$	102 $\mu$ s
Max. no. of lum. on circuit break. B16 A	20
Max. no. of lum. on circuit break. C10 A	12
Max. no. of lum. on circuit break. C16 A	20
Power factor $\lambda$	$\geq 0.90$
Total harmonic distortion	< 20 %
Protection class	I
Operating mode	Integrated LED driver

**Photometrical data**

Luminous flux	4500 lm
Luminous efficacy	90 lm/W
Color temperature	4000 K
Light color (designation)	Cool White
Color rendering index Ra	$\geq 80$
Standard deviation of color matching	< 6 sdc <sub>m</sub>
Luminous intensity	-
Flickering metric (Pst LM)	-
Stroboscope effect metric (SVM)	-
Photobiological safety group acc. to EN62778	RG1
Beam angle	110 ° x 110 °

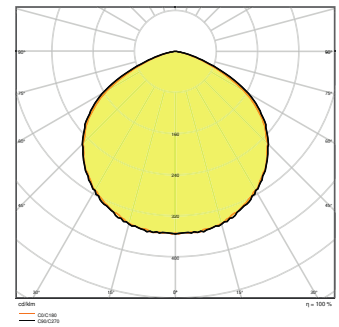

Body material	Aluminum
Cover material	Glass
Light emitting surface material	Glass
Glow Wire Test according to IEC 60695-2-12	650 °C
Mercury content	0.0 mg

### Application & Mounting

Ambient temperature range	-20...+45 °C
Type of connection	Cable, 3-pole
Type of protection	IP65
Protection class IK (shock resistance)	IK06
Dimmable	No
Mounting type	Surface
Mounting location	Wall / Ceiling / Floor
Application environment	Outdoor
Adjustable	Yes
LED module replaceable	Not replaceable

### Lifespan

Lifespan L70/B50 at 25 °C	30000 h <sup>1)</sup>
Number of switching cycles	10000

<sup>1)</sup> t[h]: L70 / B50 @ 25 °C (Ta), t[h]: L80 / B10 @ 25 °C (Ta), t[h]: L90 / B10 @ 25 °C (Ta)

### Certificates & Standards

Standards	CE / CB / TÜV SÜD / EAC
Luminaire with limited surface temperature, "D sign"	No
Ball shot safe	No

### DOWNLOAD DATA

#### Documents and certificates



Declarations Of Conformity CE

#### Photometric and lighting design files



IES file (IES)

Photometric and lighting design files



LDT file (Eulumdat)



UGR file (UGR table)



LDC typ cone



LDC typ polar

LOGISTICAL DATA

Product code	Packaging unit (Pieces/Unit)	Dimensions (length x width x height)	Gross weight	Volume
4058075268647	Folding box 1	60 mm x 216 mm x 259 mm	1119.00 g	3.36 dm <sup>3</sup>
4058075268654	Shipping box 8	445 mm x 250 mm x 280 mm	28982.00 g	31.15 dm <sup>3</sup>

The mentioned product code describes the smallest quantity unit which can be ordered. One shipping unit can contain one or more single products. When placing an order, for the quantity please enter single or multiples of a shipping unit.

ADDITIONAL CATALOG INFORMATION

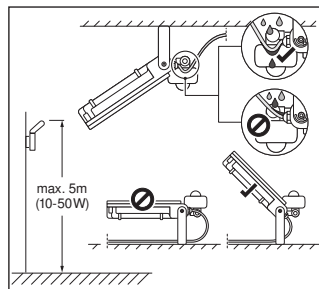
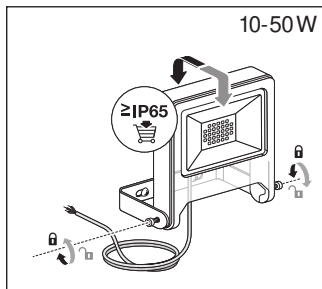

References / Links

- For Guarantee see [www.ledvance.com/guarantee](http://www.ledvance.com/guarantee)

DISCLAIMER

Subject to change without notice. Errors and omission excepted. Always make sure to use the most recent release.